

Theelin Hearth Products

How To Replace the T1 Sensor in the Parlour & Gnome Pellet Stove

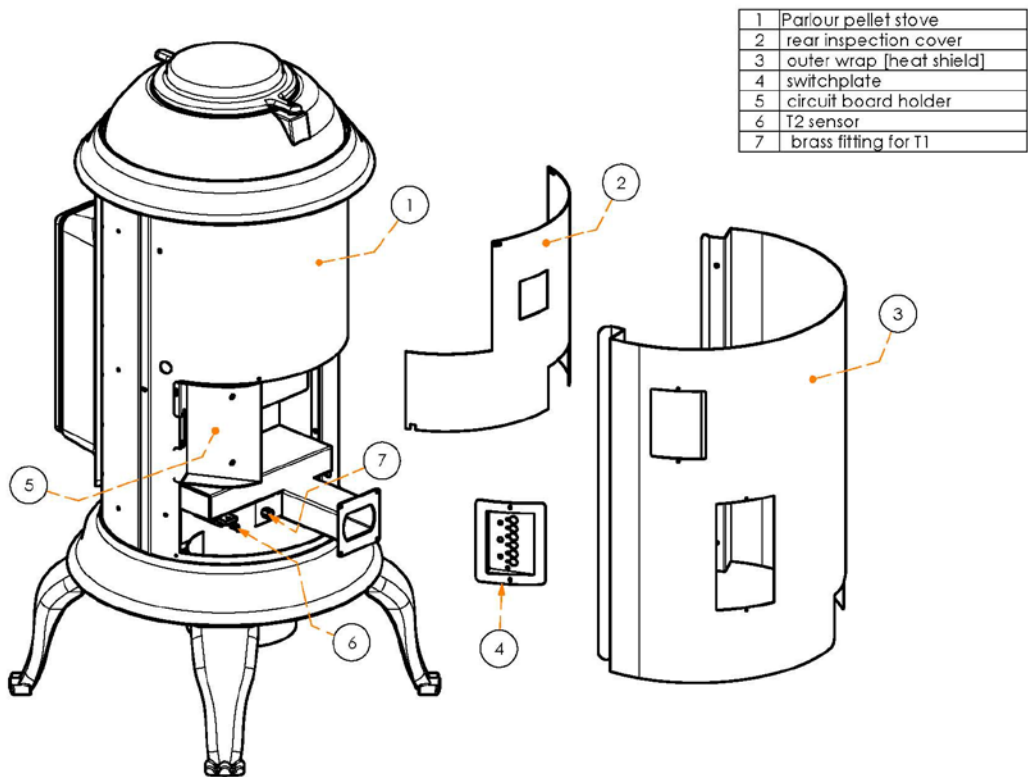

How to Replace the T1 Sensor in the Parlour & Gnome Pellet Stove

Step 1

CAUTION: Unplug power cord prior to performing any service on stove. Ensure stove has cooled down.

Locate Switch Panel on stove. When facing the front of the stove the Switch Panel is located on the right hand side.



Step 2

Remove (2) black 8-32 phillips pan head screws.



Step 3

Carefully lift Switch Panel out of Wrapper and unplug connector.

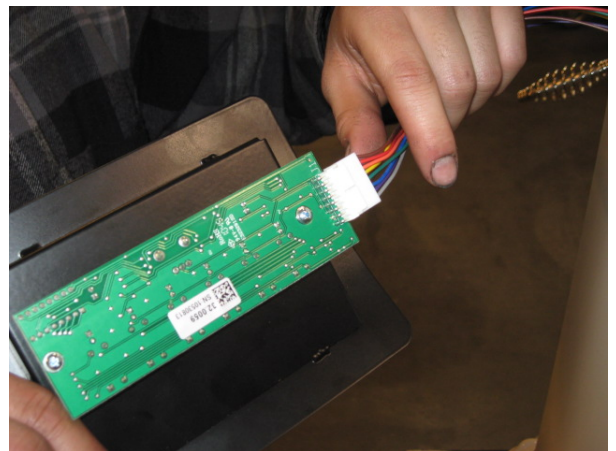

How to Replace the T1 Sensor in the Parlour & Gnome Pellet Stove

Step 4

Apply masking tape to Bottom Ring below the front of the Wrapper (both sides). This will protect the Bottom Ring from scratches while the Wrapper is removed.



Step 5

Apply masking tape to Bottom Ring below the front of the Wrapper (both sides). This will protect the Bottom Ring from scratches while the Wrapper is removed.



Step 6

Place a rag over the Exhaust Port in the back of the stove. This will protect the Wrapper when removing the Wrapper.



How to Replace the T1 Sensor in the Parlour & Gnome Pellet Stove

Step 7

Locate the (6) T30 Torx screws on the left and right hand side of the Wrapper.

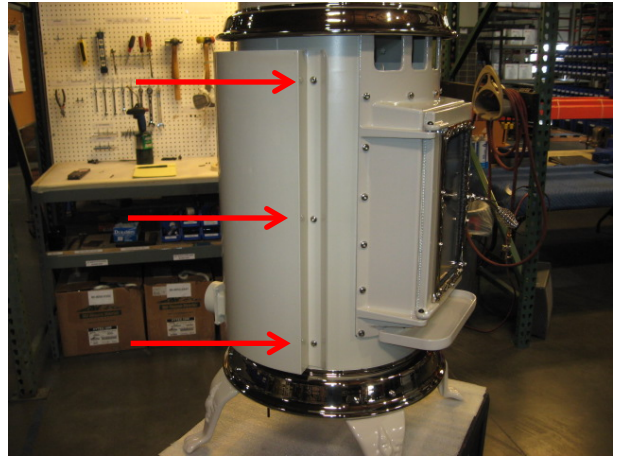

Step 8

Locate the (6) T30 Torx screws on the left and right hand side of the Wrapper.



Step 9

Carefully remove all (6) T30 Torx screws with a T30 driver.

*Note: when replacing the Wrapper, the stainless steel washer goes between the screw head and the Wrapper. The mica washer goes between the Wrapper and the stove.



How to Replace the T1 Sensor in the Parlour & Gnome Pellet Stove

Step 10

Carefully remove the Wrapper from the stove.



Step 11

Locate the (4) 8-32 black philips pan head screws on Rear Inspection Cover.

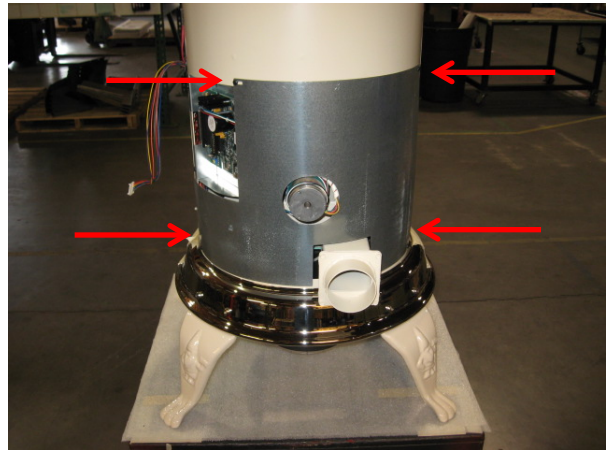

Step 12

Remove top (2) 8-32 black philips pan head screws from Rear Inspection Cover.



How to Replace the T1 Sensor in the Parlour & Gnome Pellet Stove

Step 13

Loosen, but do not remove, the bottom (2) 8-32 black philips pan head screws on the Rear Inspection Cover.

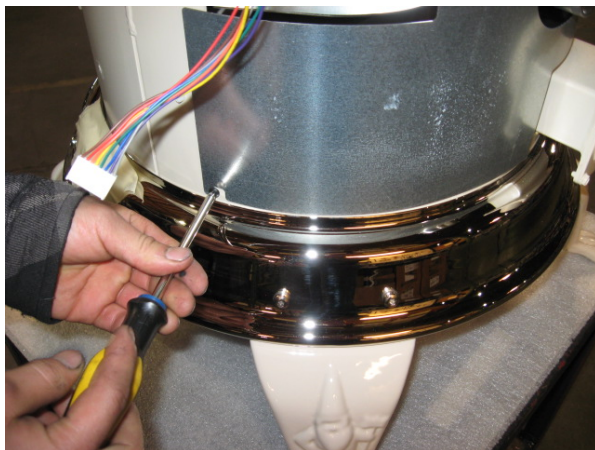

Step 14

Remove Rear Inspection Cover.



Step 15

Locate the T1 Sensor.

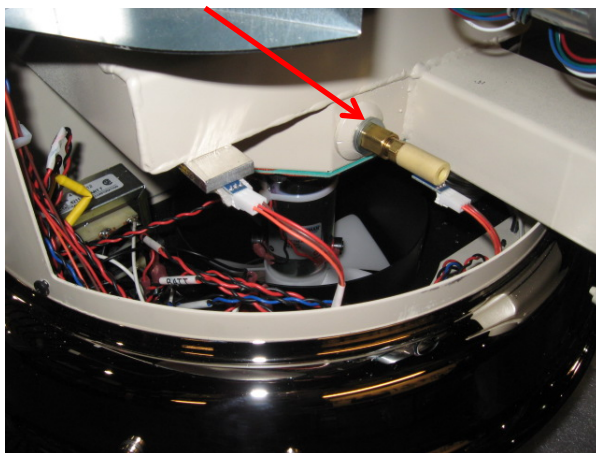

How to Replace the T1 Sensor in the Parlour & Gnome Pellet Stove

Step 16

Unplug T1 Sensor.

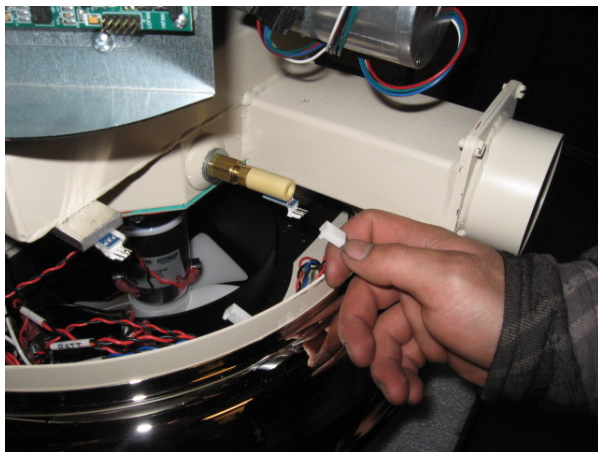

Step 17

Using a 7/16 open ended wrench, loosen the brass hex nut holding the T1 Sensor to the brass fitting.

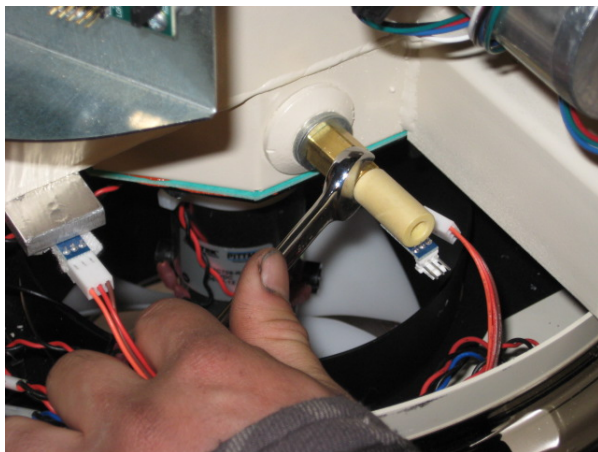

Step 18

Unscrew and remove T1 Sensor from the stove.

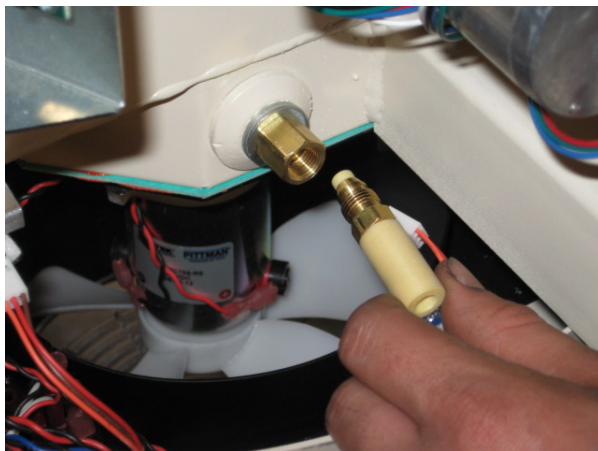

How to Replace the T1 Sensor in the Parlour & Gnome Pellet Stove

Step 19

Remove brass hex nut and brass bushing from T1 Sensor.



Step 20

It may be necessary to clip the tip of the T1 Sensor to free the brass bushing and hex nut from the sensor.



Step 21

Install brass hex nut and bushing on new T1 Sensor. Sanding the tip of the new sensor and inside of the brass bushing may be necessary to allow the bushing to freely slide into position.

Reassembly stove in reverse order of removal.

